

WB

Dimensions in mm. Other tolerances according to standard shaft W.

Length tolerance: ± 3 mm, separating cut deburred.

Distance tolerance $\pm 0,2$ mm, P1 = P2

Positional tolerance of thread \varnothing ($\pm 0,2$ mm).

Thread depth = A

Thread dimension = C and S.

Other pitch available on request.

Contact us for CAD-files.

Material: Quenched and tempered steel Cf53 / 1.1213 / C53G

Surface hardness: 59 HRC min.

Standard Tolerance: ISO h6



General Data

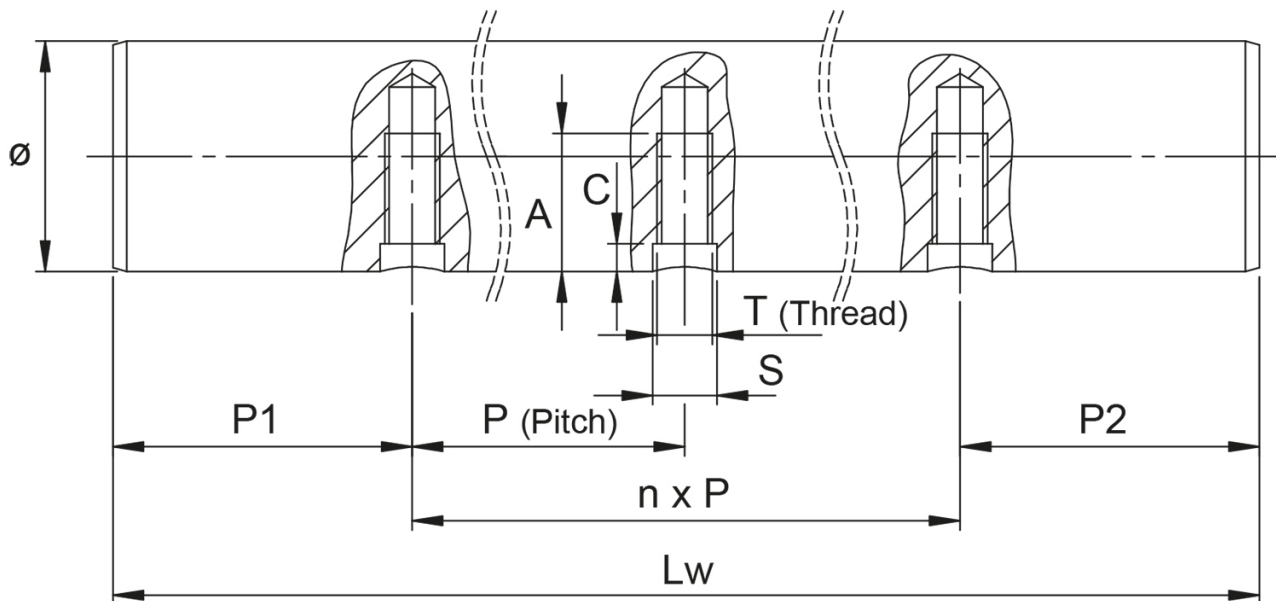

Designation	S	A	C	T	P1
WB12	5	7	2	M4	37.5
WB16	6	9	2.5	M5	50
WB20	7	11	3	M6	50
WB25	9	15	3	M8	60
WB30	11	17	3.5	M10	75
WB40	11	19	4	M10	100

Designation	P	Diameter	Lw (mm)
WB12	75	12	6000
WB16	100	16	6000
WB20	100	20	6000
WB25	120	25	6000
WB30	150	30	6000
WB40	200	40	6000